

Installation instructions for KZNG5-01927-00, KZNG5-01928-00 Under Run Protective Shield Fuel Tank

LEXUS GX



TOYOTA LC



Model Year: **GX 460 - 2009 - 2013 -**

**LC 150 Diesel -
2009 - 2013 - 2015 -**

LC 150 Petrol - 2009 - 2013 -

Vehicle Code: **URJ150L-GKTZKW**

KDJ15*L-G*YW**

GRJ150L-G*KW**

Part Number:

Steel: KZNG5-01927-00
Aluminium: KZNG5-01928-00



Weight:

Steel: 13,49 kg
Aluminium: 8,91 kg



Installation Time:

40 min

KZNG5-01927-00, KZNG5-01928-00

A

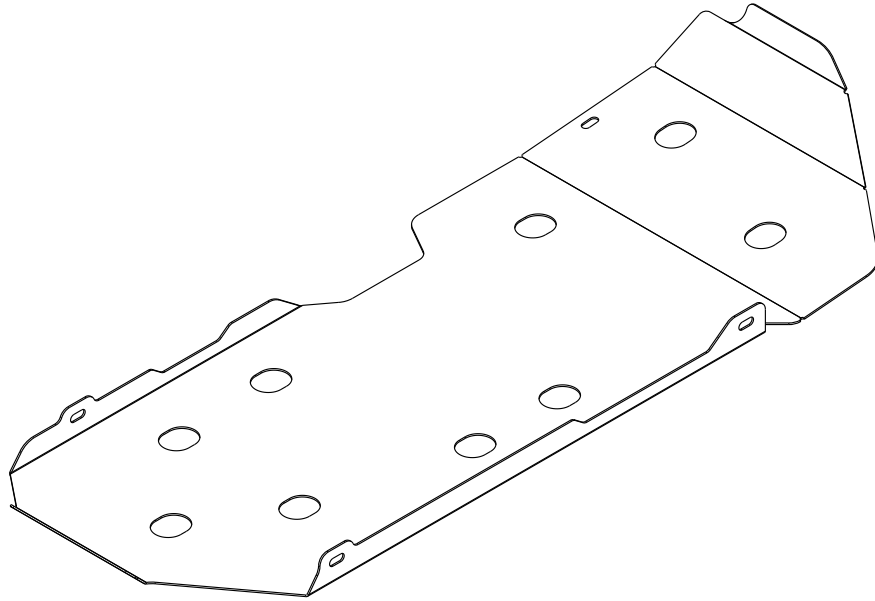

1x

KZNG5-01927-60

B1

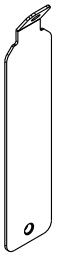

1x

B2

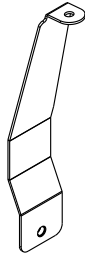

1x

B3

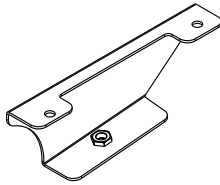

1x

B4

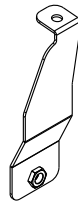

1x

C

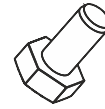

M10x20

4x

D

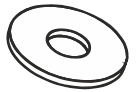

Ø 10

4x

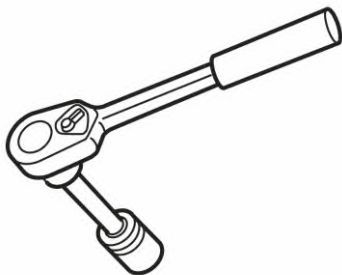

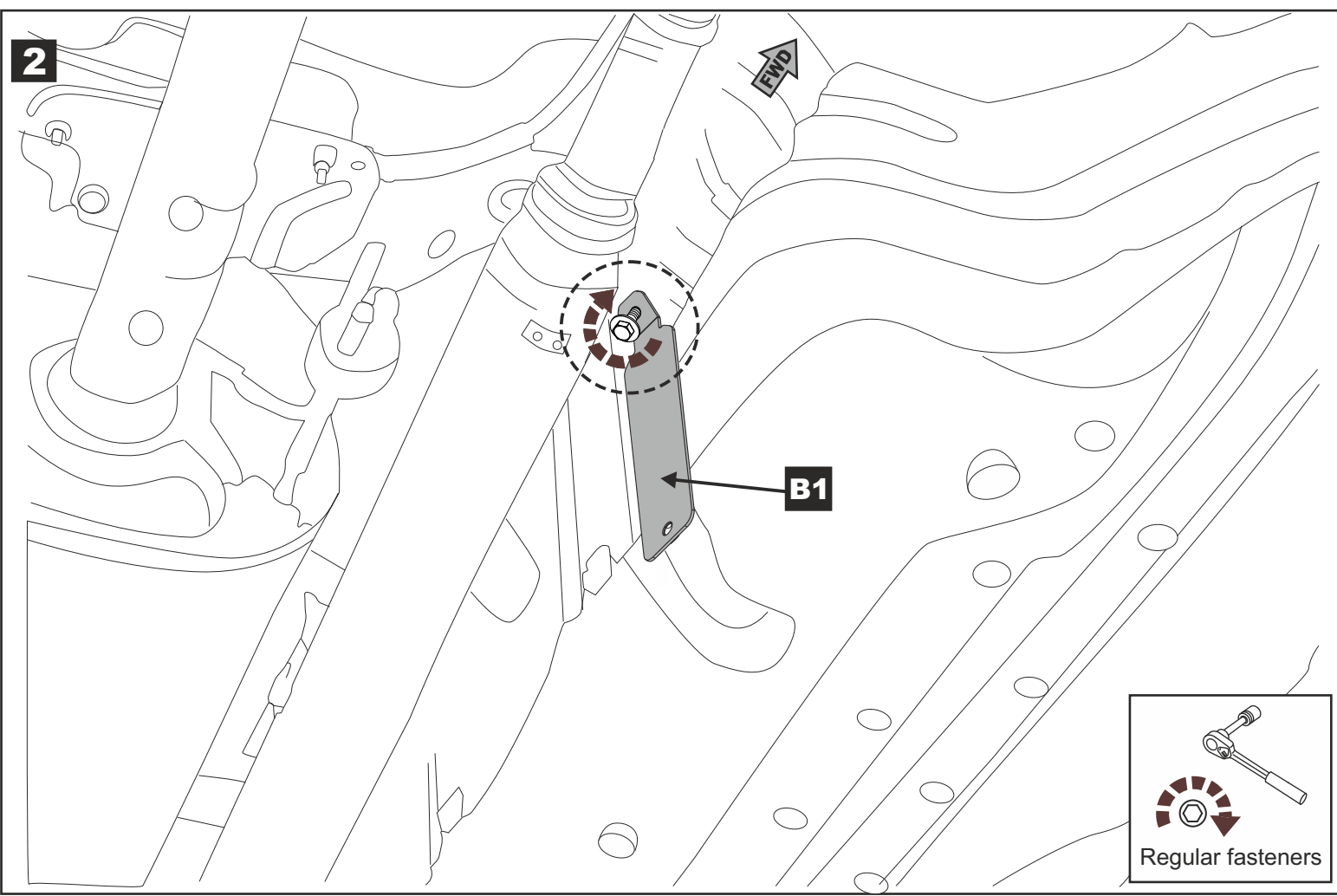
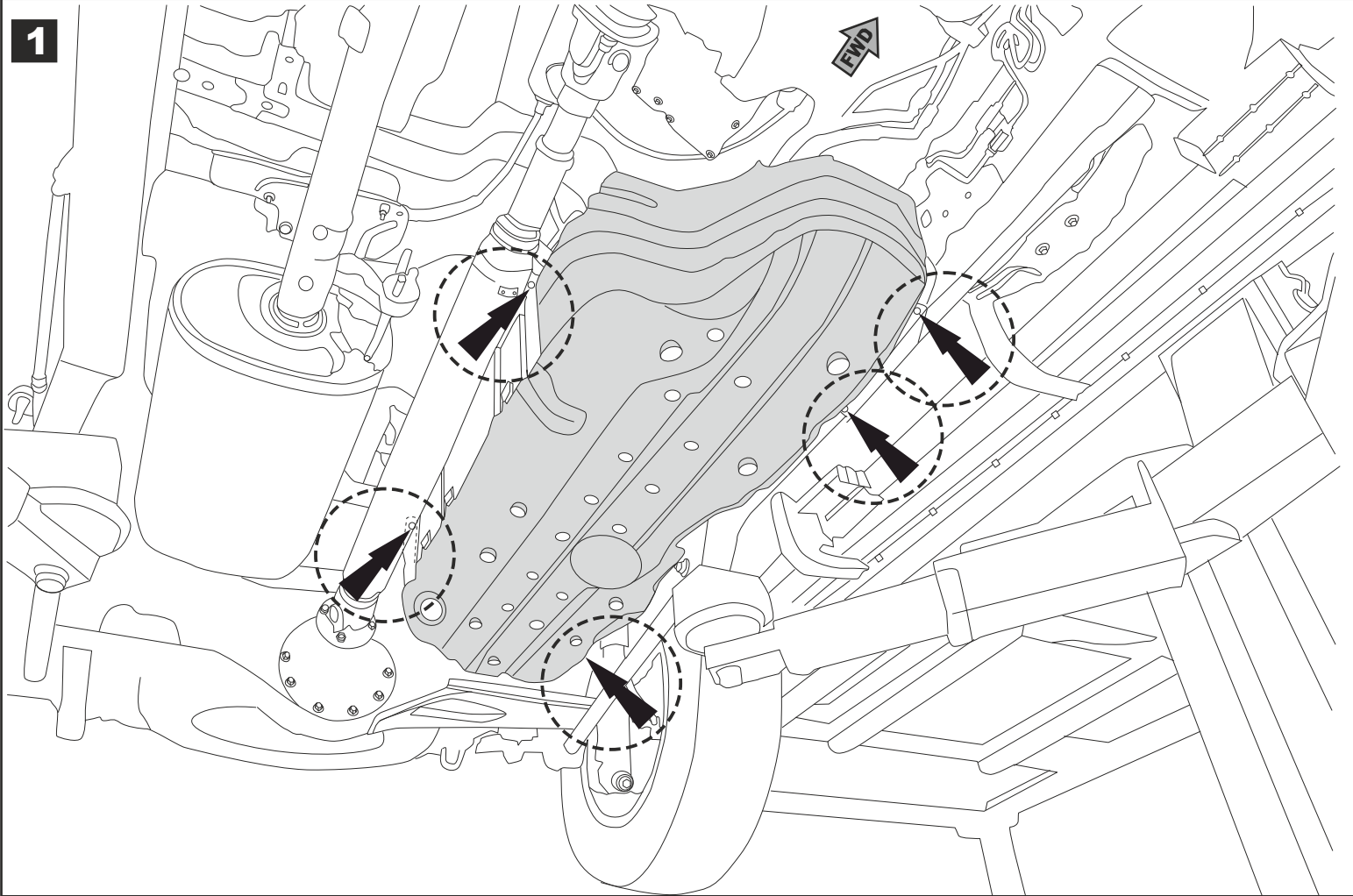

3

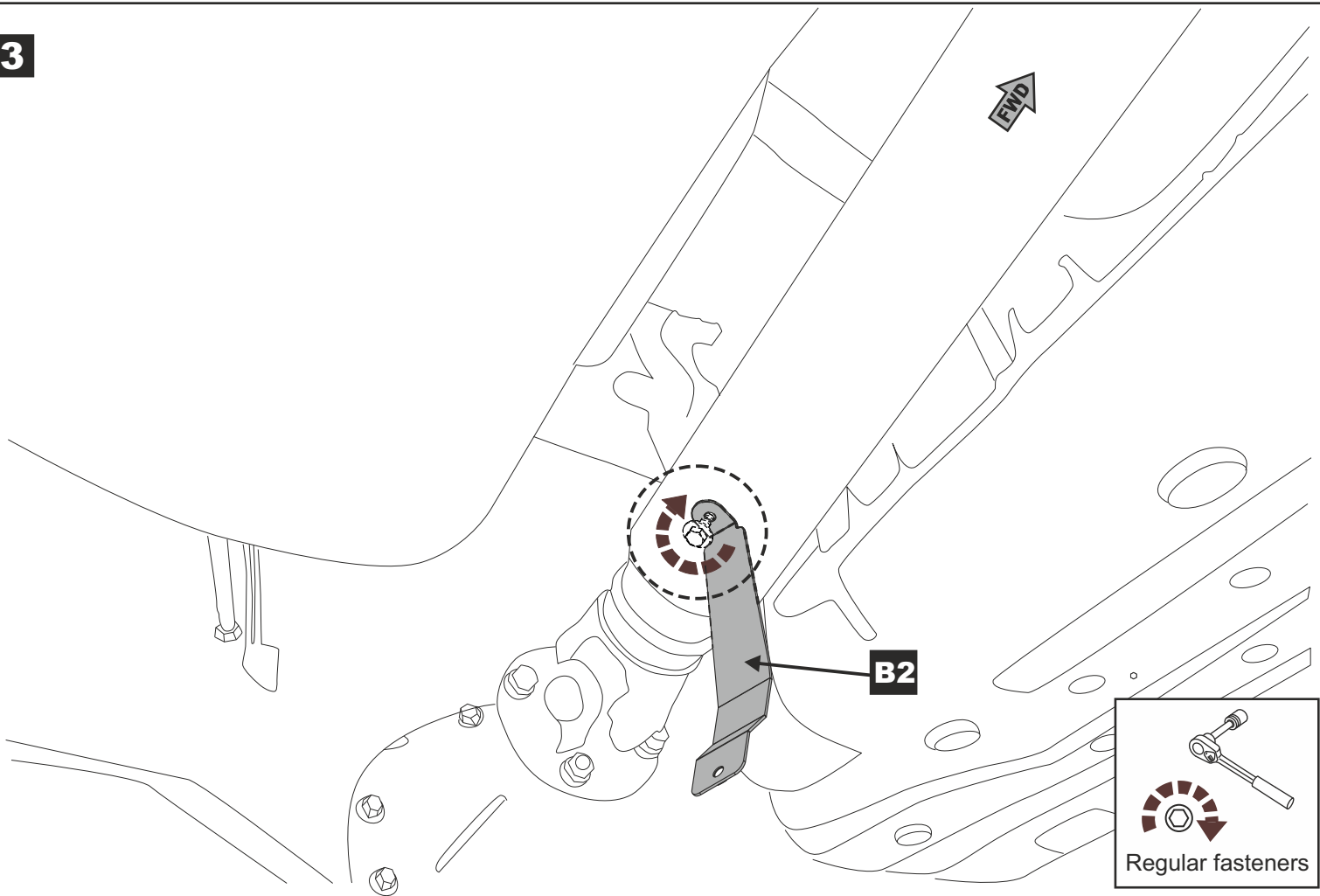

4

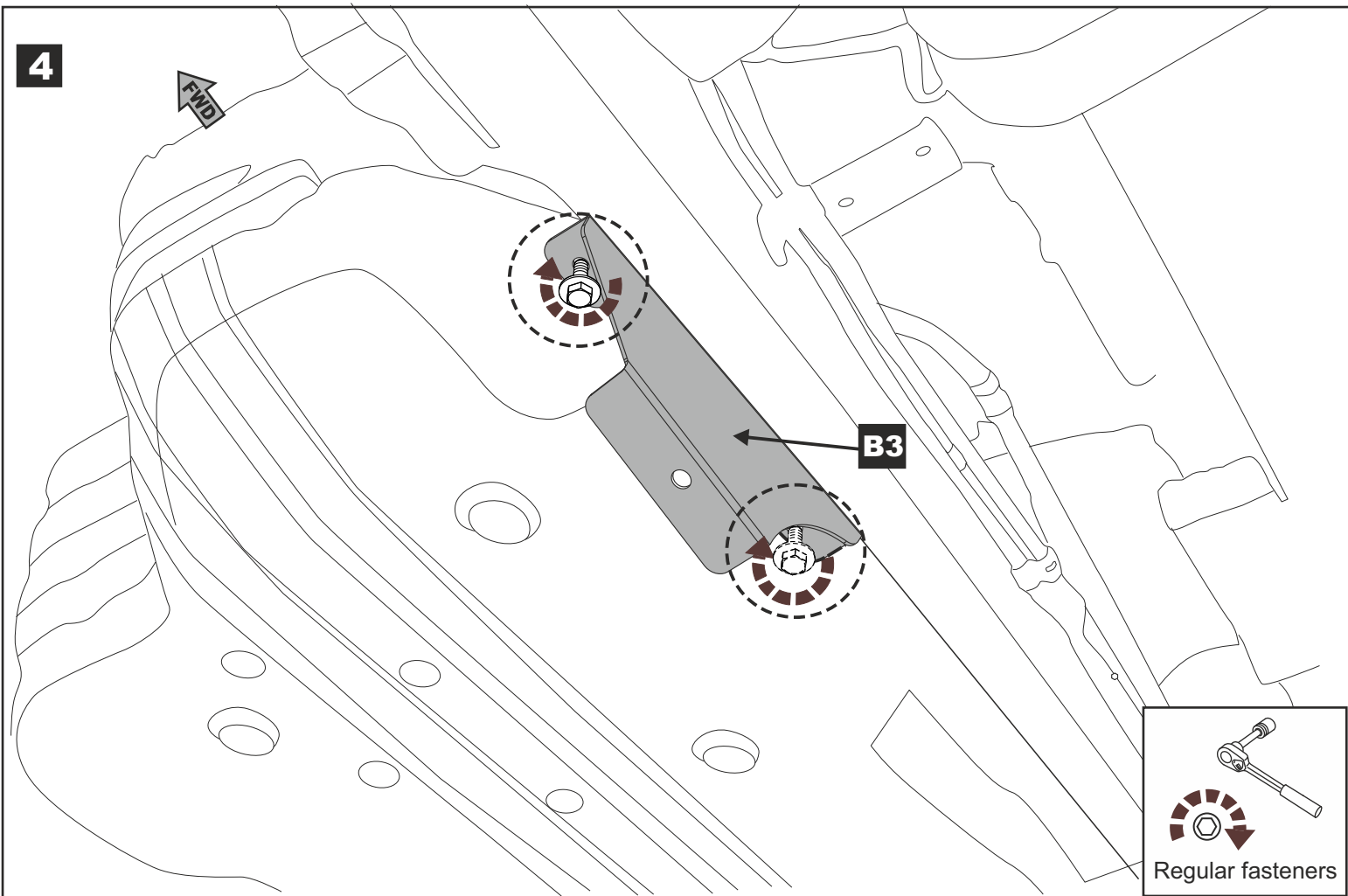

5

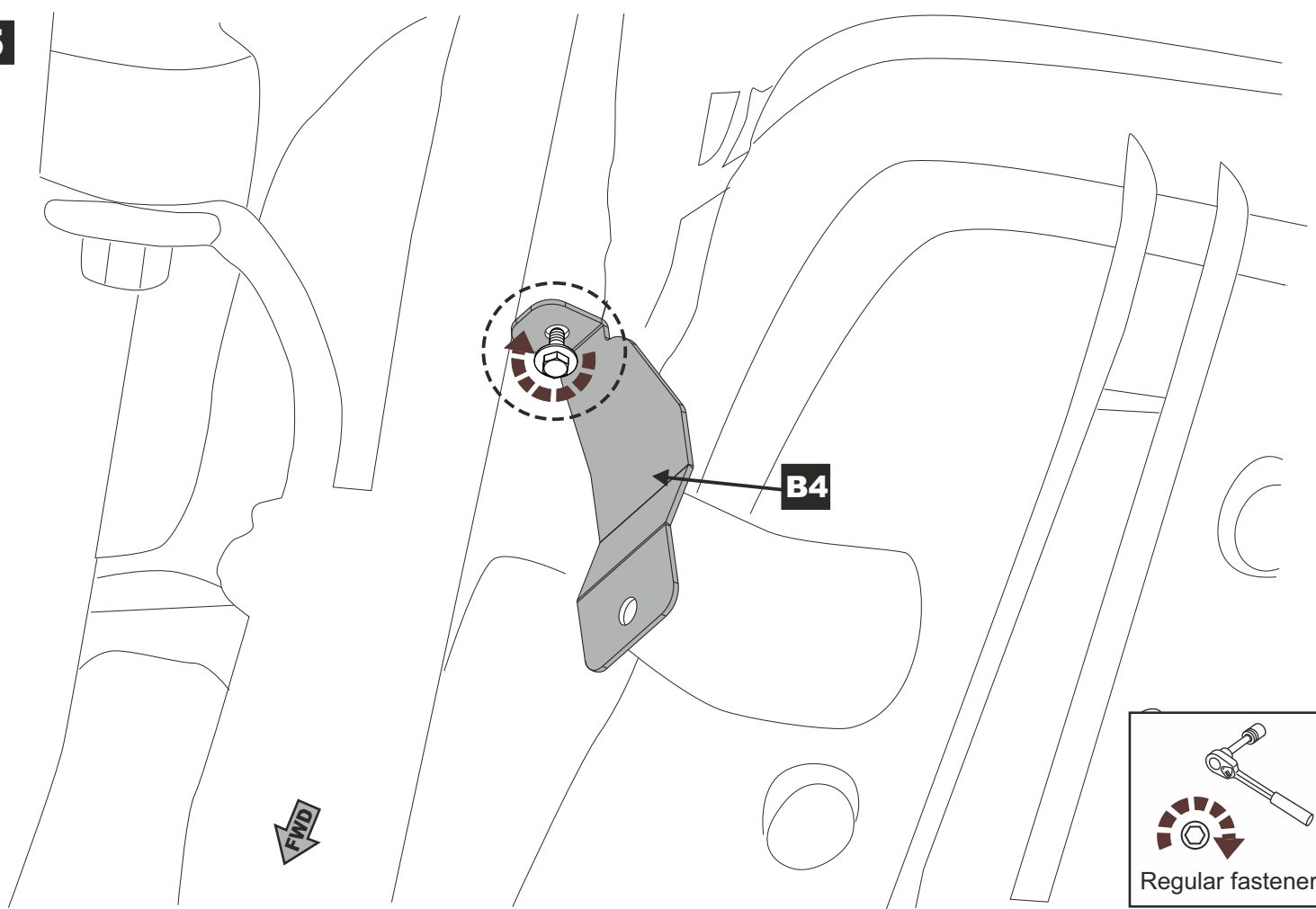

6

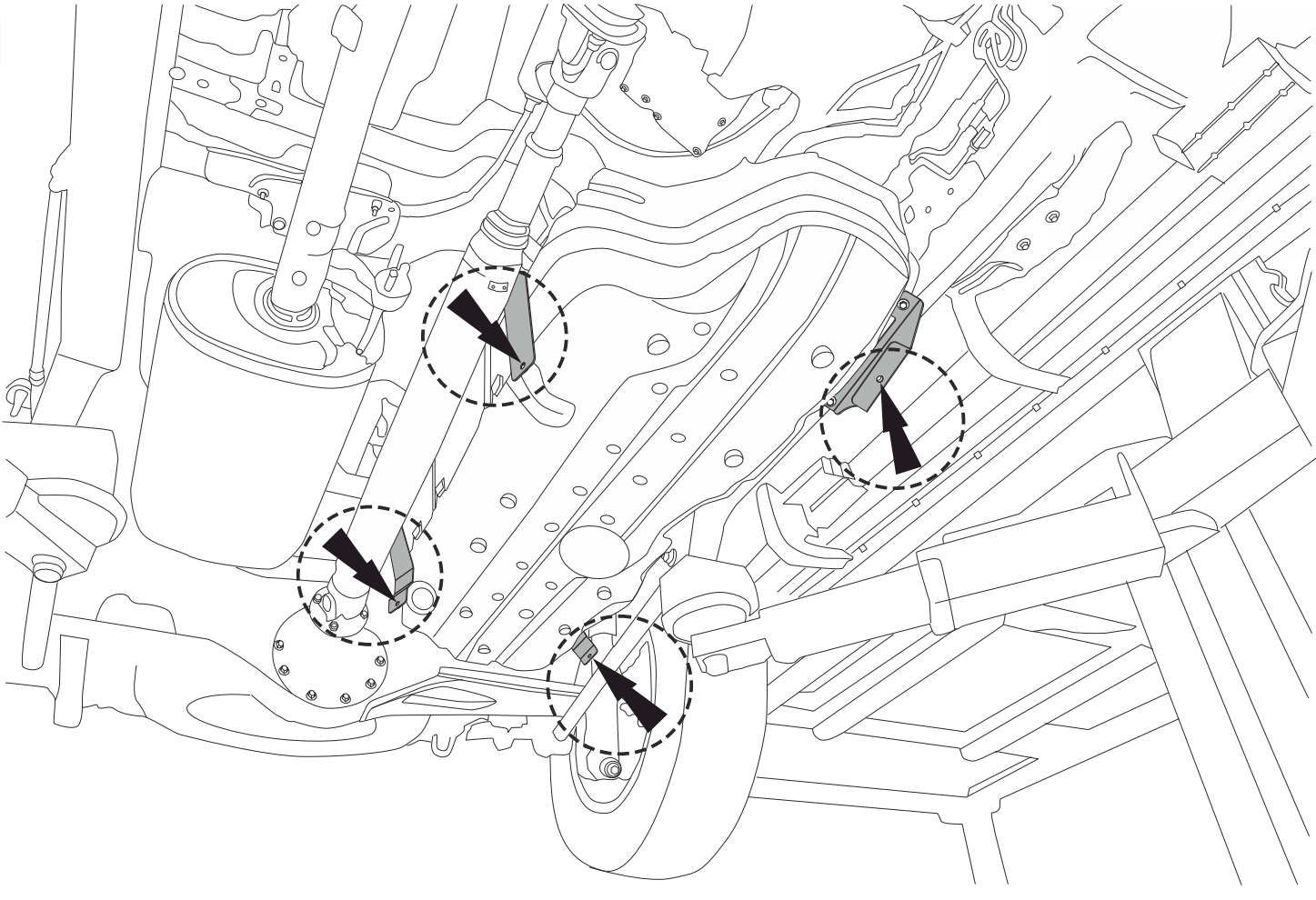

7

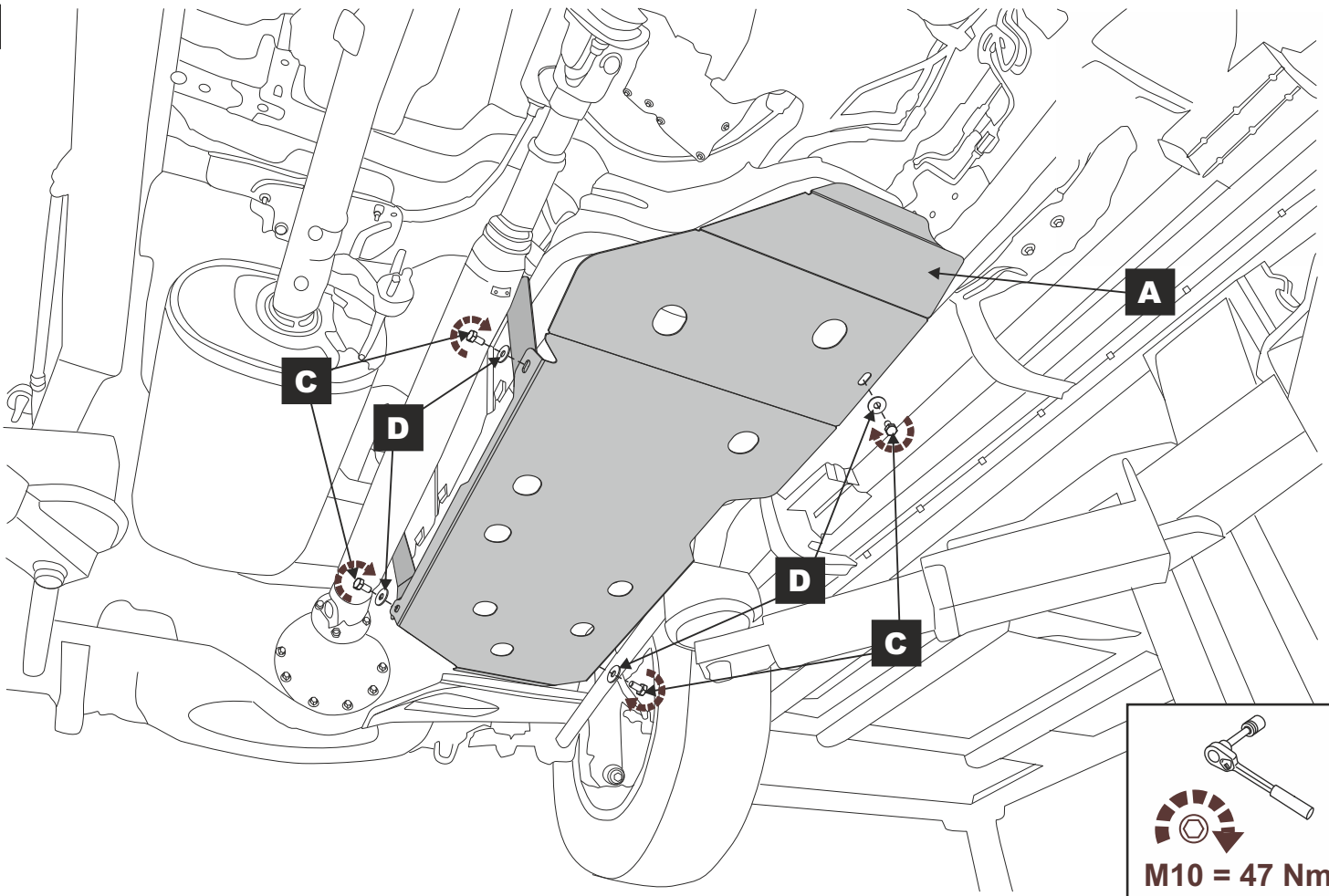

8

